

ALL DIMENSIONS TO BE CHECKED ON SITE  
 NO DIMENSIONS TO BE SCALED FROM THIS DRAWING  
 DRAWING IS TO BE READ IN CONJUNCTION WITH RELEVANT CONSULTANTS DRAWINGS

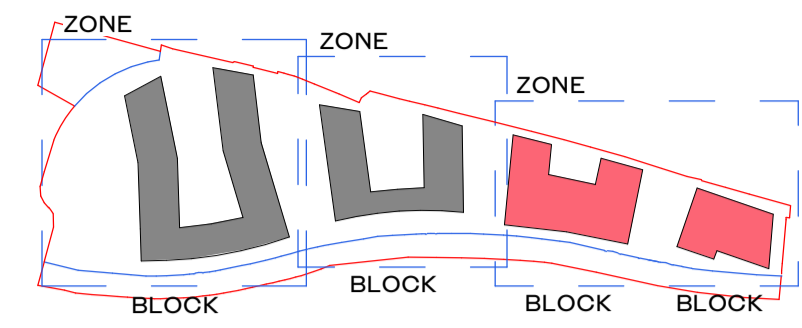

**SITE DRAWINGS LEGEND:**  
 REFER TO BARRET MAHONY CIVIL ENGINEERING DRAWINGS FOR ALL DRAINAGE/ ROAD INFORMATION.  
 SURVEY INFORMATION PROVIDED BY JONES ENGINEERING ON 23.4.2019.  
 PLEASE REFER TO THE PAUL HOGARTH COMPANY LANDSCAPE DRAWINGS FOR ALL INFORMATION ON EXISTING AND PROPOSED TREES, MATERIAL FINISHES AND LAYOUT. ANY REFERENCE TO TREES/ HARD OR SOFT LANDSCAPING IN THIS DRAWING ARE INDICATIVE ONLY.

- EXISTING BUILDING
- PLANNING APPLICATION SITE BOUNDARY
- PLANNING APPLICATION OWNERSHIP OF APPLICANT

ALL APARTMENT TYPES SHOULD BE READ IN CONJUNCTION WITH DRAWING NO.S P1601, P1602, P1603, P1604 AND HOUSING QUALITY

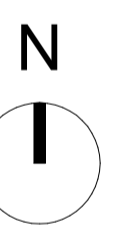

REV	DATE	DESCRIPTION	CHK	DRN
P2	26/11/2019	ISSUED FOR PLANNING APPROVAL	DB	OJ
P1	05/08/2019	ISSUED FOR PIC REQUEST	DB	OJ

STATUS CODE DESCRIPTION  
**ISSUED FOR PLANNING APPROVAL**

CLIENT  
 Atlas GP Limited

PROJECT  
 Project Claremont

DRAWING  
 BLOCK C&D - BASEMENT PLAN

PROJECT NUMBER  
 950520

DATE  
 26/11/19

SCALE@ A1:  
 As indicated

DRAWN/CHECKED:  
 OJ/ DB

REVISION  
 P2

DRAWING NUMBER  
 CLR-HJL-03-B01-DR-A-1008CD

STATUS CODE:  
 A1



1 ZONE 03 - BLOCK C&D - B01 BASEMENT  
 1:200